

# 圆柱头内六角螺钉 装有平垫圈

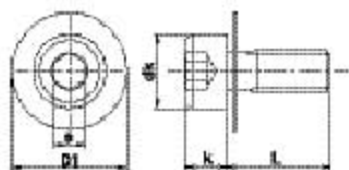

	M3	M4	M5	M6
dk	5.5	7	8.5	10
k	3	4	5	6
s	2.5	3	4	5
D1	8	10	12	13

- 材料 铁
- 表面处理 三价镀锌件  
黑色三价镀锌件
- 强度区分 10.9

L \ d	M3	M4	M5	M6
6	1000	1000		
8	1000	1000	500	
10	1000	1000	500	300
12	1000	1000	500	300
16	1000	500	500	300
20	1000	500	300	300
25			300	200
30			200	

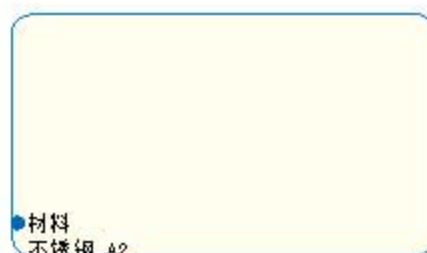

L \ d	M4	M5
8	1000	
10	1000	500
30		200