

内六角平端固定螺钉

ISO 4026 / JIS B1177 / DIN 913

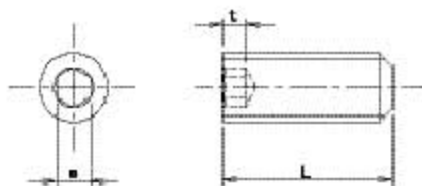

- 材料 铁
- 表面处理 三价镀锌件
黑色三价镀锌件
- 强度区分 45H



	M2	M2.5	M3	M4	M5	M6	M8	M10	M12
s	0.9	1.3	1.5	2	2.5	3	4	5	6
t	1.7	2	2	2.5	3	3.5	5	6	8

L \ d	M2	M2.5	M3	M4	M5	M6	M8	M10	M12
2	1000	** 1000							
3	** 1000	1000	1000	** 1000					
4	1000	** 1000	1000	1000	1000				
5	1000	1000	1000	1000	1000	1000			
6	** 1000		1000	1000	1000	1000			
8	** 1000	** 1000	1000	1000	1000	1000	500		
10	** 1000	** 1000	1000	1000	1000	1000	500	500	
12			1000	1000	** 1000	1000		500	* 500
14			** 1000	1000				500	
15			1000	1000	1000	1000	500	** 500	
16			1000	1000	1000	* 1000			
18				* 1000	** 1000	** 1000			
20			** 1000	* 1000	1000	1000	500	** 500	
25			** 1000	** 1000	500	500	** 500	200	
30				** 1000	500	** 500	200	200	
35					** 500		** 200	200	
40					** 500		200		

* ... 只有三价镀锌件

** ... 只有黑色三价镀锌件

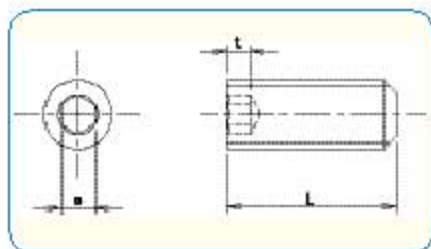

	M3	M4	M5	M6	M8	M10	M12	M16	M20	M24
s	1.5	2	2.5	3	4	5	6	8	10	12
t	2	2.5	3	3.5	5	6	8	10	12	15

●材料
不锈钢 A2

件 / 箱

L \ d	M3	M4	M5	M6	M8	M10	M12
3	1000	1000					
4	1000	1000	1000	1000			
5	1000	1000	1000	1000			
6	1000	1000	1000	1000	500		
8	1000	1000	1000	1000	500	500	
10	1000	1000	1000	1000	500	500	
12	1000	1000	1000	1000	500	500	500
14	1000	1000	1000	1000	500	500	
15	1000	1000	1000	1000	500	500	500
16	1000	1000	1000	1000	500	500	
18	1000	1000	1000	1000	500	500	200
20	1000	1000	1000	1000	500	500	200
25		1000	500	500	500	200	200
30		1000	500	500	200	200	200
35							200
40					200		100

●材料
SUS 316L 不锈钢 A4

件 / 箱

L \ d	M16	M20	M24
16	30		
20	30	15	
25	30	15	
30	30	15	
35	30	15	
40	30	15	10
45	30	15	
50	30	15	10
60	30	15	10
70	30	15	
80	30	15	10
100	30	15	10

