

十字平头机螺钉

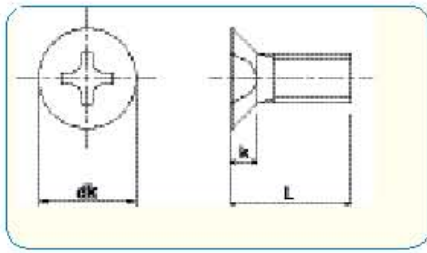

- 材 料 铁
- 表面处理 三价镀锌
黑色三价镀锌



	M2	M2.3	M2.5	M2.6	M3	M3.5	M4	M5	M6	M8	M10
dk	4	4.6	5	5.2	6	7	8	10	12	16	20
k	1.2	1.35	1.45	1.5	1.75	2	2.3	2.8	3.4	4.4	5.7
板手尺寸	1			2				3			4

		件 / 箱										
d	L	M2	M2.3	M2.5	M2.6	M3	M3.5	M4	M5	M6	M8	M10
3	3	13,000	8,000	8,000	8,000							
4	4	12,000	8,000	6,000	6,000	4,000						
5	5	10,000	7,000	6,000	6,000	4,000	4,000	3,000				
6	6	9,000	6,000	5,000	5,000	3,500	4,000	2,500	1,200			
8	8	7,000	5,000	4,000	4,000	2,500	3,000	2,000	1,200	800		
10	10	5,000	4,000	3,000	3,000	2,200	2,500	1,800	1,100	700	300	
12	12	4,000	2,500	2,500	2,500	2,500	2,000	1,500	1,000	600	300	
14	14	3,500	2,200	2,000	2,000	2,500		1,200	800	600	250	
15	15	3,000	2,200	1,800	2,000	2,000		1,200	700	500	250	
16	16	2,500	2,000	1,800	1,800	2,000	1,600	1,200	700	500	250	250
18	18	2,500	2,000	1,500	1,600	1,800		1,000	600	450	200	
20	20	2,000	1,500	1,500	1,500	1,500	1,200	900	600	400	200	200
22	22	1,500				1,400		900	800	500	250	
25	25		1,000		1,000	1,200		700	700	500	220	180
30	30				800	1,000		600	600	400	200	150
35	35					700		500	500	300	180	120
40	40					600		600	400	300	160	100
45	45					800			350	250	150	100
50	50					600		450	300	200	130	80
55	55					600		400	250	200	120	80
60	60					500		300	230	180	100	70
65	65					500		300	200	150	100	70
70	70					800		300	200	120	90	60
75	75							300	200	200	90	60
80	80							300	200	200	90	50
85	85											50
90	90							400	250	170	80	50
95	95											50
100	100							400		150	80	50

* ... 只有三价镀锌

不锈钢 十字平头机螺钉

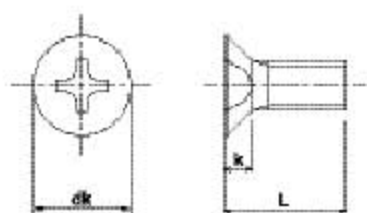

●材 料
不 锈 钢 A2



	M2	M2.3	M2.5	M2.6	M3	M4	M5	M6	M8	M10
dk	4	4.6	5	5.2	6	8	10	12	16	20
k	1.2	1.35	1.45	1.5	1.75	2.3	2.8	3.4	4.4	5.7
扳手尺寸	1					2		3		4

L \ d	件 / 箱									
	M2	M2.3	M2.5	M2.6	M3	M4	M5	M6	M8	M10
3	10,000									
4	10,000	10,000	8,000	8,000	3,000					
5	10,000	8,000	6,000	6,000	2,000	2,000				
6	10,000	8,000	6,000	6,000	2,000	1,000	1,000			
8	8,000	6,000	5,000	4,000	2,000	1,000	1,000	500		
10	6,000	6,000	4,000	4,000	2,000	1,000	1,000	500		
12	6,000	4,000	3,000	3,000	2,000	1,000	500	500	200	
14	4,000	4,000	2,500	2,000	2,000	1,000	500	500	200	
15	4,000	3,000	2,500	2,000	1,000	1,000	500	500	200	
16	3,000	3,000	2,500	2,000	1,000	1,000	500	200	200	100
18	3,000	2,000	2,000	2,000	1,000	500	500	200	200	
20	3,000	2,000	2,000	2,000	1,000	500	500	200	100	100
22						500	500			
25	2,000	1,000	1,500	1,000	1,000	500	500	200	100	100
30	1,000	1,000	1,000	1,000	1,000	500	200	200	100	100
35					500	500	200	200	100	50
40					500	200	200	100	50	50
45					500	200	200	100	50	50
50					500	200	100	100	50	50
55						200	100	100	50	50
60						200	100	100	50	50
65						200	100	100	50	50
70						200	100	100	50	50
75						200	100	100	50	50
80						200	100	100	50	50
90						200	100	50	50	50
100						200	100	50	50	50

十字平头机螺钉

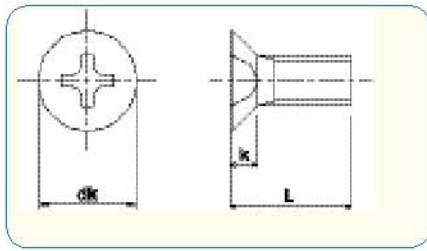

	M3	M4	M5	M6	M8
dk	6	8	10	12	16
k	1.75	2.3	2.8	3.4	4.4
扳手尺寸	2			3	

●材料

SUS 316L 不锈钢 A4



件 / 箱

L \ d	M3	M4	M5	M6	M8
5	500				
6	500	300			
8	500	300	200		
10	500	300	200	100	
12	500	300	200	100	
15	500	300	200	100	50
16	500	300	200	100	50
20	500	300	200	100	50
25	500	300	200	100	50
30	500	300	200	100	50
35		300	200	100	50
40	500	300	200	100	50
45		300	200	100	50
50		300	200	100	50
55		300	200	100	50
60		300	200	100	50
65		300	200	100	50
70			200	100	50
75			200	100	50
80				100	50
90				100	50
100				100	50

●材料

钛



件 / 箱

L \ d	M3	M4	M5	M6
6	500	300		
8	500	300	200	
10	500	300	200	100
12	500	300	200	100
15	500	300	200	100
16	500	300	200	100
20	500	300	200	100
25	500	300	200	100
30	500	300	200	100
35		300	200	100
40		300	200	100
45			200	100
50			200	100
60				100

真空螺钉 十字平头机螺钉

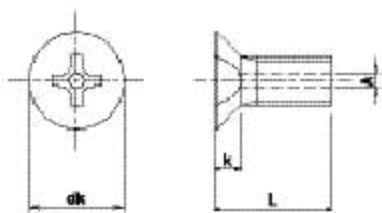

- 材料：镀层
- 不锈钢 A2
- 不锈钢 A2，特殊化学抛光



	M3	M4	M5	M6
dk	6	8	10	12
k	1.75	2.3	2.8	3.4
A	1.2	1.5	1.5	2
扳手尺寸	2		3	

- 材 质
- 不锈钢 A2

		件 / 箱			
L \ d	M3	M4	M5	M6	
5	20	20			
6	20	20	10		
8	20	20	10	10	
10	20	20	10	10	
12	20	20	10	10	
16		20	10	10	
20			10	10	
25				10	



RoHS
2002/95/EC
符合 RoHS 指令

●材 质

不锈钢 A2，特殊化学抛光

		件 / 箱			
L \ d	M3	M4	M5	M6	
5	20	20			
6	20	20	10		
8	20	20	10	10	
10	20	20	10	10	
12	20	20	10	10	
16		20	10	10	
20			10	10	
25				10	