

内六角圆头螺钉 ISO 7380 / JIS B1174

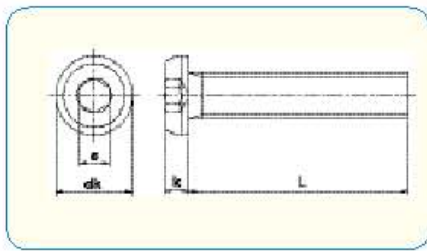

●材料

钛



遵从 RoHS 指示

	M3	M4	M5	M6	M8
dk	5.7	7.6	9.5	10.5	14
k	1.65	2.2	2.75	3.3	4.4
s	2	2.5	3	4	5

		件 / 箱				
L \ d	M3	M4	M5	M6	M8	
6	1000					
8	1000	1000	1000	500		
10	1000	1000	500	500		
12	1000	1000	500	500	200	
15	1000	1000	500	500	200	
16	1000	1000	500	500	200	
20	1000	1000	500	500	200	
25		1000	500	500	200	
30		1000	500	500	200	

内六角平头螺钉 JIS B1194 / DIN 7991

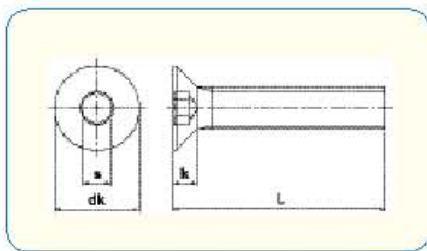

●材料

钛



遵从 RoHS 指示

	M3	M4	M5	M6	M8
dk	6.72	8.96	11.2	13.44	17.92
k	1.86	2.48	3.1	3.72	4.96
s	2	2.5	3	4	5

		件 / 箱				
L \ d	M3	M4	M5	M6	M8	
6	1000					
8	1000	1000	1000	500		
10	1000	1000	500	500		
12	1000	1000	500	500	200	
15	1000	1000	500	500	200	
16	1000	1000	500	500	200	
20	1000	1000	500	500	200	
25		1000	500	500	200	
30		1000	500	500	200	

钛：纯净的钛 JIS H4870 TW270 or TW340.